

ENGLISH
ESPAÑOL

TRUPER®

Manual

Steam cleaner

2.4 HP

Power

1/4 gal

Capacity

Applies for:

Code

103206

Model

LV-1800

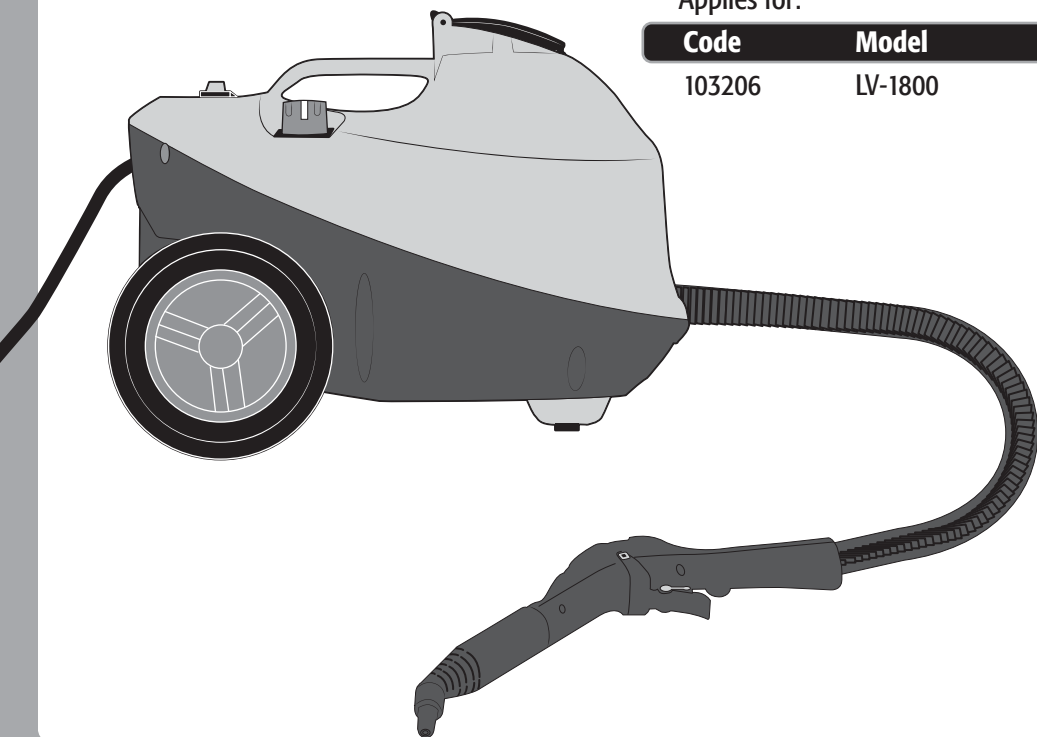

LV-1800

CAUTION



Caution read this manual
before using the tool.



Technical data	3
Electrical requirements	3
 Safety instructions	4
 Specific safety regulations for the use of steam cleaner	6
Parts	7
Assembly	8
Operation	10
Maintenance	13
Troubleshooting	14
Authorized service centers	15
Warranty policy	16

CAUTION

To get the most out of the tool, extend its lifespan, claim the warranty if necessary, and avoid serious risks or injuries, please read this manual thoroughly before using the tool.

Keep this manual for future references.

The illustrations in this manual are for reference only and may differ from the real appearance of the tool.



LV-1800

Code	•	103206
Description	•	Steam cleaner
Voltage	•	127 V ~
Frequency	•	60 Hz
Current	•	15 A
Tank capacity	•	1/4 gal
Maximum steam time	•	40 min
Maximum steam temperature	•	212 °F
Maximum pressure	•	50 PSI
Nominal pressure	•	30 PSI
Adjustable steam rate	•	20 g/min – 40 g/min
Heat exchanger material	•	Aluminum
Heating time	•	1 minute
Steam hose length	•	8 ft
Power cord length	•	13.1 ft
Weight	•	7.5 lb
Conductors	•	14 AWG x 3C with insulation temperature of 221 °F

The power cord holder type: Y
 The construction class of the tool is: Basic insulation.
 The thermal insulation class of the motor windings is: Class H.

⚠ WARNING If the power cord is damaged, it must be replaced by the manufacturer or a TRUPER Authorized Service Center to prevent any risk of electric shock or significant accidents. The electrical insulation of this tool is altered by splashes or spillage of liquids during its operation. Do not expose it to rain, liquids, and/or moisture.



⚠ WARNING WARNING Before accessing the terminals, all power circuits must be disconnected.

Electrical requirements

⚠ WARNING In case of failures or breakdowns, the grounded connection provides a pathway with minimum resistance for electrical current, which reduces the risk of electrical shock. This tool is equipped with an electrical cord that features a grounded conductor and plug. The plug must be connected to an outlet that is installed and grounded according to all local codes.

⚠ WARNING When using an extension cord, make sure to use the proper gauge to carry the current your tool will consume. An undersized cord will cause voltage drops in the line, resulting in power loss and motor overheating. The following table shows the correct size to be used depending on the cord length and the amperage capacity indicated on the tool's data plate. If in doubt, use the next higher gauge.

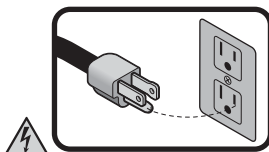

Capacity in Amperes	Number of conductors	Extension gauge	
		from 5.9 ft to 49.2 ft	higher than 49.2 ft
from 0 A to 10 A	3 (one to ground)	18 AWG(*)	16 AWG
from 10 A to 13 A		16 AWG	14 AWG
from 13 A to 15 A		14 AWG	12 AWG
from 15 A to 20 A		8 AWG	6 AWG

* It is allowed to use it if the extensions themselves have an overcurrent protection device.

AWG = American Wire Gauge. Reference: NMX-J-195-ANCE.

⚠ WARNING When operating electric tools outdoors, use a grounded extension cord marked as **VOLTECK**. 'Outdoor Use'. These extensions are specially designed for outdoor use and reduce the risk of electric shock.





All operators must read these instructions before using the equipment.

Any electrical appliance can be dangerous if used incorrectly. Some of the safety warnings in this manual apply generally to many household appliances. Other warnings are specific for this electric steam cleaner. Always follow these safety guidelines. Failure to do so may result in personal injury or property damage.

WARNING This equipment can be dangerous! Careless or incorrect use can cause serious injuries.

WARNING • This machine is for domestic use only.

• Before using this tool, make sure that all individuals operating it have read and understood all safety instructions and other information provided in this manual. Keep this manual and review it regularly before using the tool and when instructing others on the correct operating procedures.

• Before using the steam cleaner, it is essential to become familiar with the controls, especially understanding how to stop the steam cleaner in case of an emergency. Only individuals who fully comprehend the instructions and are proficient in operating the machine should use the steam cleaner. Keep the steam cleaner out of reach of children at all times.

• Keep this manual for future reference.

1. Do not immerse in water.

2. For household use only.

3. For indoor use only.

4. Not suitable for space heating.

5. Keep spectators and children away: all spectators including children and pets, should stay at a safe distance from the work area.



6. Disconnect the tool: when not in use, disconnect the steam cleaner from the power source, before servicing, during transportation, or when changing accessories.

7. Do not use in hazardous environments: do not use the steam cleaner in rain or in wet or damp areas. Do not operate the steam cleaner in gaseous or explosive environments.

8. Check for damaged parts: before using the steam cleaner, repair or replace any damaged parts. Also, check the alignment of moving parts and their fittings, breakage of parts or any other condition that may affect the operation of the tool. Periodically inspect the appliance cord. If damaged, repair the tool at a TRUPER Authorized Service Center. Extension cords should also be periodically inspected and replaced immediately if damaged.

9. Avoid accidental starts: ensure the switch is off before plugging in the appliance.

10. Use the right tool: do not force the tool or any accessory in to the tool to perform a task for which they were not designed.

11. Carefully perform maintenance: keep tools clean for optimal and safe performance. Follow instructions for changing accessories. If the appliance does not operate as it should, or has been dropped, damaged, left outdoors, or submerged in water, call the TRUPER Customer Service Center.

12. Use recommended accessories: Check the owner's manual for recommended accessories. The use of incorrect accessories may cause risk of injury.

13. Do not force the cord: Never use the cord for carrying the appliance or pull it to unplug the tool. Keep the cord away from heat, oil and sharp edges.

14. Do not force the tool. The tool will perform better and safer when used at the intended place.

15. Do not exceed yourself: keep both feet firmly planted on the ground and always maintain balance.

16. When not in use, store the tool indoors: The steam cleaner should be stored indoors, out of reach of children, in a dry and enclosed place.

17. Be alert, watch what you are doing, and use common sense when handling a tool. Do not use it if you are tired or under the influence of drugs, alcohol, or medication.

18. Keep the trigger safety lock active when the tool is not in use to prevent accidental tripping.

WARNING To ensure continuous protection against electric shock risk, plug the tool only into properly grounded electrical outlets.

Personal safety

Do not clean with steam or use this steam cleaner near flammable liquids, gases, or explosive vapors such as gasoline or other fuels, light fluids, cleaners, oil-based paints, natural gas, hydrogen, or explosive powders such as coal dust, magnesium dust, grain dust, or gunpowder. Sparks generated by the unit can ignite flammable vapors or powders.

• This steam cleaner is for indoor use only. Do not use it outdoors.

• This appliance is not intended for use by individuals (including children) whose physical, sensory, or mental capabilities are different or reduced, or who lack experience or knowledge, unless they are supervised or instructed by a person responsible for their safety. Children should be supervised to ensure that they do not play with the appliances.

• Use safety equipment. Always wear eye protection. The use of safety equipment such as safety glasses, dust mask, slip-resistant shoes, helmet, and ear protection in appropriate conditions significantly reduces the risk of personal injury.





Safety instructions



TRUPER

- Never leave a machine that is ready to operate unattended in the workplace.
- Do not use the tool with a damaged plug. If the tool does not work properly or has been dropped, damaged, left outdoors, or submerged in water, contact the TRUPER Customer Service department.
- Do not use if the nozzle is not in place.
- Carefully inspect your appliance before using it and follow all label and marking instructions.
- Do not handle the plug or unit with wet hands.
- To reduce the risk of health hazards from vapors or dust, do not clean toxic materials with steam.
- Do not store the cleaner near hazardous materials.
- Do not leave the cleaner unattended when plugged in. When not in use, unplug it from the power source.
- Keep hair, loose clothing, fingers, and all body parts away from openings.
- Maintain proper posture and exercise extra caution when using the appliance on stairs.
- Product maintenance should be performed only by qualified personnel. Otherwise it could result in injury to the user or damage to the product.
- This steam cleaner is intended for domestic use only. Commercial use of this product is prohibited and will void the manufacturer's warranty.
- Never wet or spray the unit with water or any other liquid. Clean the unit after each use as described in the cleaning and storage section.
- Always operate the machine in a horizontal position. Do not operate it tilted to one side or even upside down.

⚠ WARNING Electric shock can cause **SERIOUS INJURY** or **DEATH**. Pay attention to the following warnings:

- While operating, do not allow any part of the electric steam cleaner to come into contact with water. If the appliance gets wet while it is off, dry it before turning it on.
- Do not use an extension cord longer than 3 meters. The steam cleaner features a 5-meter power cord. The total combined length of the cord should not exceed 8 meters. Any extension cord should be gauge 14 (or thicker) to safely power the steam cleaner.
- Do not touch the appliance or its plug with wet hands or while standing in water. Wearing rubber boots provides protection.

Table of extension cord

Cord length	3 m (10 ft)
Minimum cord gauge	14

5. To prevent the appliance cord from disconnecting from the extension cord during operation, tie a knot with both cords as shown in the table.

Table 1 Extension cord securing method

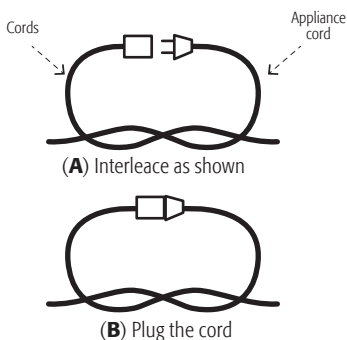

Electrical safety

1. Ground fault circuit interrupter (GFCI) protection must be provided on the circuit or outlet used for this electric steam cleaner. Receptacles with built-in GFCI protection are available for use for this safety measure.
2. Ensure that the main voltage matches the rating label on the unit. The use of incorrect voltage can damage the steam cleaner and cause injury to the user.
3. To prevent electric shocks, use only with an appropriate indoor extension cord. Before using, check that the extension cord is in good condition. When using an extension cord, make sure to use the proper gauge to carry the current your tool will consume. An undersized cord will cause voltage drops in the line, resulting in power loss and motor overheating.
4. Use only a 3-wire extension cord with a 3-prong grounding plug and a 3-slot receptacle that accepts the product plug.

6. Do not force the cord. Never pull the steam cleaner by the cord or disconnect it by pulling on it. Keep the cord away from heat, oil, and sharp edges.
7. To provide continuous protection against electric shock risk, plug it into properly grounded electrical outlets only.



The manufacturer will not be responsible for injuries resulting from the incorrect use of the device or from use that does not comply with the instructions.

NOTE: This steam cleaner is designed exclusively for indoor household use.

⚠ WARNING To reduce the risk of electric shock, do not use it outdoors or in wet or damp environments. Do not expose it to rain. Store it in a dry indoor location.

⚠ WARNING For your own safety, read and understand the operator's manual. Do not leave the unit unattended while operating.

⚠ DANGER This steam cleaner should not be used on electronic devices.

⚠ WARNING To reduce the risk of injury, disconnect the unit before performing maintenance.

⚠ WARNING Never leave the brushes or nozzles on any surface for more than a few seconds. Prolonged exposure to heat and moisture can damage surfaces.

- Do not operate the unit without water in the tank.
- Do not overfill the water tank. The unit can hold a maximum of 1 L (0.25 gal) of water. Overfilling the water tank can cause damage to the machine and injury to the operator.
- Do not fill the water tank with any liquid other than water. Other cleaning agents could damage the unit or cause injury. The use of distilled or demineralized water to minimize mineral deposit buildup is HIGHLY RECOMMENDED.
- Do not operate the machine with an empty or partially filled tank. Always fill the tank with water before each start-up and after long periods of inactivity.
- Do not operate the unit for more than 1 hour at a time.
- Do not aim steam towards people, animals, or electrical devices.
- Do not touch the nozzle or attempt to attach accessories while the unit is in use. Do not touch the accessories or attempt to place the cotton cloth while the unit is in use.
- NEVER tilt or rotate the machine when it is on or producing steam.
- Do not unplug by pulling the cord. Always grasp the plug to disconnect it from the power source.
- Do not expose the machine to freezing temperatures.
- Do not place the unit on a wet surface or operate it near a water source.
- Do not place the unit on a towel, blanket, or other insulating cushion.
- Do not submerge in water.
- Not suitable for heating spaces.

Safety symbols

The following table shows and describes the safety symbols that may appear on this product. Read, understand, and follow all instructions on the machine before attempting assembly and operation.



Safety Alert. Caution



To reduce the risk of electric shock, do not use it outdoors or in wet or damp environments. Do not expose it to rain. Store it indoors in a dry place.



Immediately disconnect the plug from the power source if the power cord is damaged, worn, or tangled. Always keep the power cord away from heat, oil, and sharp edges.



To reduce the risk of injury, the user must read the instruction manual.



WARNING! Always turn off the machine and disconnect the power supply before conducting inspections, cleaning, and maintenance. Immediately disconnect the plug from the outlet if the cable is damaged or cut.



Risk of burns, the surface of the appliance heats up during operation. Not suitable for heating spaces.

Get to know your electric steam cleaner

Read the user manual and safety instructions carefully before operating the electric steam cleaner. Compare the illustration with the electric steam cleaner to familiarize yourself with the location of the various controls and settings. Keep this manual for future reference.

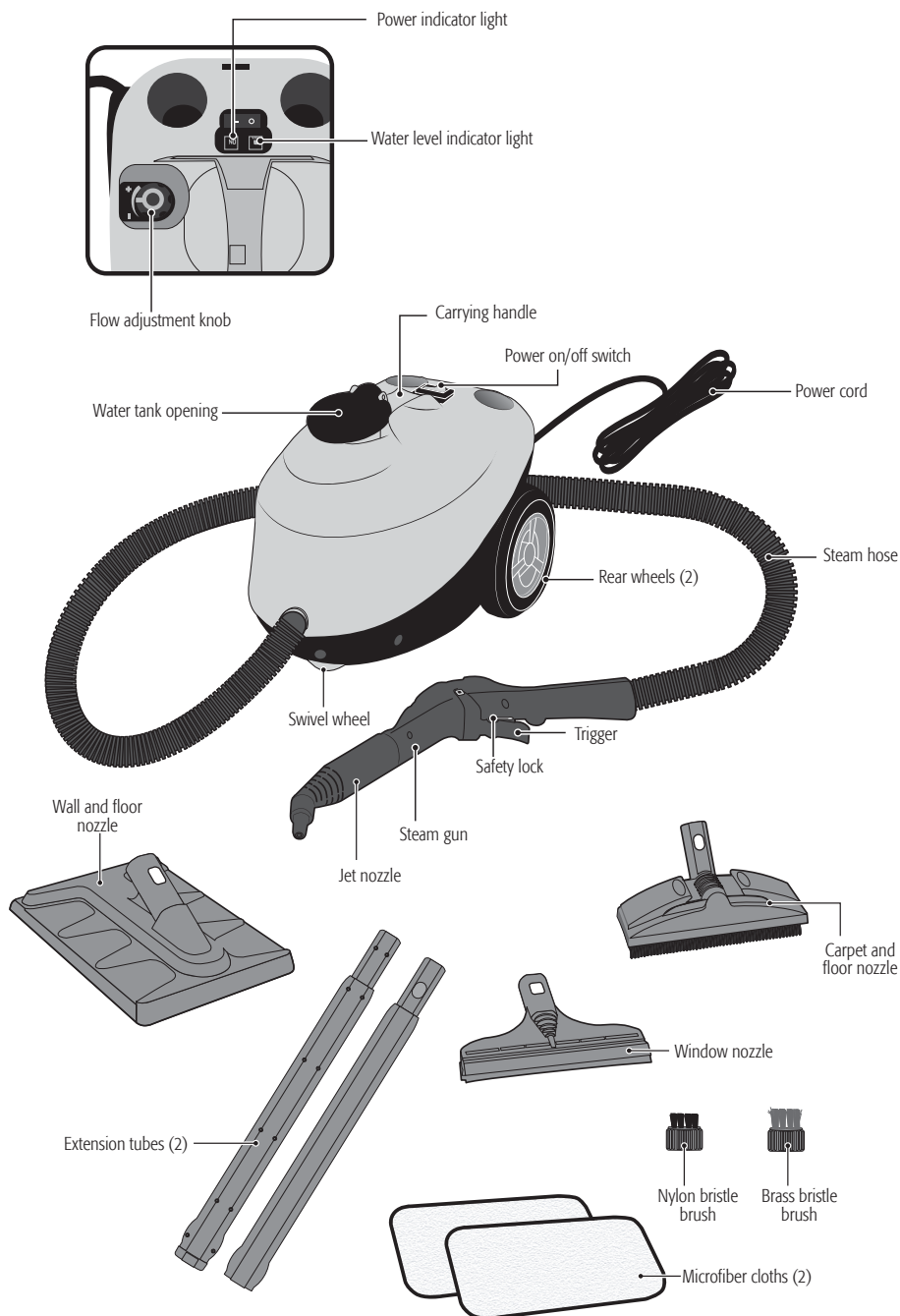

- ⚠ WARNING** To prevent serious personal injury, read and understand all safety instructions provided.
- ⚠ WARNING** Before performing any maintenance, ensure that the tool is disconnected from the power source. Failure to do so could result in serious personal injury.
- ⚠ WARNING** To avoid personal injury, ensure that the switch is in the OFF position before attaching or removing any accessory.
- ⚠ WARNING** Allow accessories to cool down before making any nozzle changes. Newly used nozzles are hot from steam.

Changing brush attachments

Press and hold the release button on the steam gun to attach the carpet and floor nozzle, window nozzle, jet nozzle, extension tubes, or wall and floor nozzle. Press the release button on the steam gun while sliding the accessory until it clicks into place **(A)**.

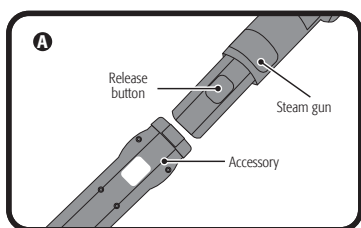

To attach any brush accessories, align the notches on both the brush and the jet nozzle and snap the brush into the nozzle **(B)**.

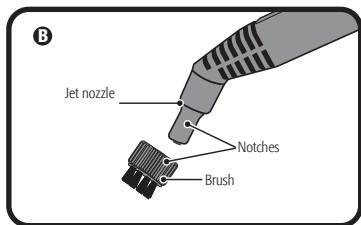

To detach the accessories, press the release button on the steam gun and slide the accessory out of the steam gun **(C)**.

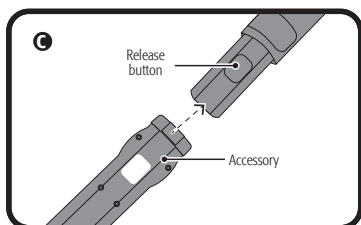

Using the accessories

NOTE: All accessories use different amounts of steam. For example, steam cleaning with the steam gun uses less water than wallpaper removal with the wall and floor nozzle. Using less water will provide longer steam time.

The large cleaning brush can be used with or without the cotton cloth. It can be used to clean large surface areas such as upholstery, ceramics, stone, parquet, marble, granite, linoleum, and carpets **(D)**.

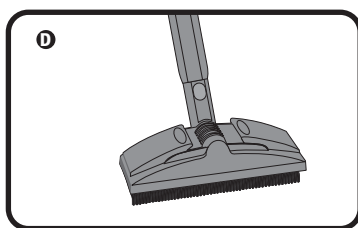

1. Stretch the microfiber over a flat surface **(E)**.
2. Place the floor nozzle grid over the microfiber and insert the ends into the notches **(F)**.
3. Insert the floor nozzle into the grid. Ensure the grid locks onto the tabs on the edge of the nozzle **(G)**.
4. Insert the remaining ends into the spaces between the nozzle and the grid to ensure the microfiber is securely attached.
5. If using fabrics other than those included with the equipment, use the side clips on the nozzle to ensure a firm hold of the fabric.

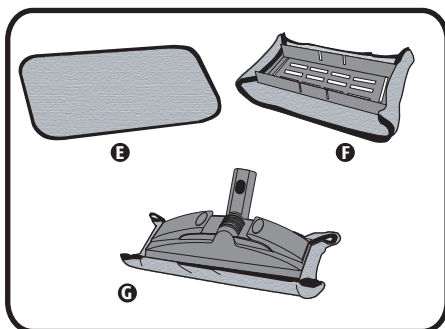

6. Use the jet nozzle to disinfect bathroom and kitchen accessories and small areas (**I**).

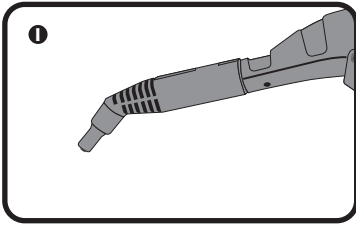

7. Use the window nozzle to clean shower doors, bathroom walls, fireplace doors, windows, and tiles. The squeegee blade of the window/tile cleaner can be used to scrape off dirt and grime loosened by steam. Do not use it on glass when the temperature is below 0 °C (32 °F), as the glass may break in cold temperatures (**J**). To clean glass, spray steam with the lowest flow possible onto the glass with the jet nozzle to preheat the surface. Using the window nozzle for more than 1 minute in the same spot or on unpreheated glass can shatter the glass. Never clean glass with the steam regulator at maximum.

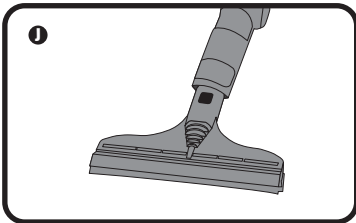

8. Use the wall and floor nozzle only for wallpaper removal. For best results, use a scraper or scoring tool to lightly score the wallpaper in a crosshatch pattern before applying steam. Perforations will help steam penetrate the wallpaper. To remove it, place the flat steam plate against the scored wallpaper. Hold down the trigger for 15 to 20 seconds. Repeat this process in sections and remove the steamed section with a scraping blade (**K**).

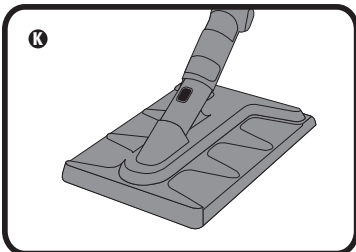

9. Use the nylon brush in hard-to-reach areas, such as joints and around bathroom sinks and faucets. Use the brass brush to remove grease and dirt on grills and ovens (**L**).

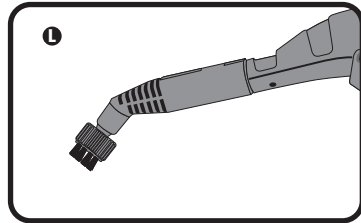

10. Use the extensions to ease floor cleaning and reach higher or narrower areas (**M**).

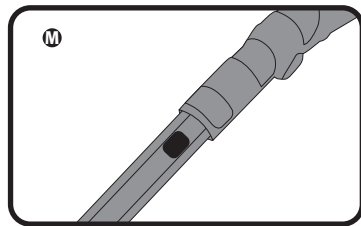

NOTE: This steam cleaner can be used with or without accessories. Check page 8 for accessory assembly instructions.

⚠ CAUTION ONLY USE CLEAN WATER TO FILL THE STEAM CLEANER; DO NOT USE ANY OTHER LIQUIDS.

Do not use household cleaners, bleach, or other chemicals with this steam cleaner.

⚠ WARNING NEVER use more than two extensions when using the steam cleaner.

⚠ WARNING NEVER attach extensions or accessories while the unit is emitting steam.

NOTE: It is recommended to use distilled water. Mineral scale deposits from tap water may shorten the lifespan of the steam cleaner.

On and Off

Before using the steam gun on the surface you wish to clean, spray it into an empty sink or bucket to purge any remaining cold water. Before turning on the unit, always check the power cord for possible damage. Use only intact cords.

⚠ WARNING Damaged cords pose a serious risk of injury. Replace them immediately.

⚠ WARNING Before turning on the steam cleaner, ensure it is not in contact with any foreign objects.

1. Open the water tank lid, fill the tank with 1 L of clean tap water (distilled water is recommended). **DO NOT OVERFILL.** A full tank will provide 20 to 40 minutes of continuous steam depending on the accessory used (**N**).

NOTE: It is recommended to use a funnel or other container (not provided) is to fill the tank.

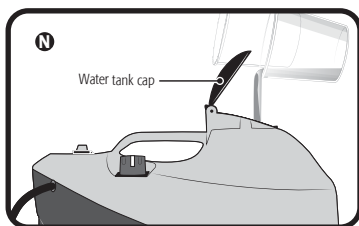

2. Ensure the accessories are properly assembled to the unit.
3. Verify that the electrical supply voltage and frequency match those specified on the rating plate. Plug the power cord into the outlet. If an extension is used, tie a knot with the two cords as shown in Table 1 on page 3.

4. To start the unit, move the switch to the ON position (**I**) as indicated (**O**).

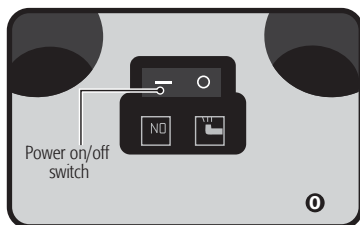

5. Before using the steam cleaner, wait 60 seconds until the unit heats up. If the green light is flashing, the unit is still heating up. If the green light is steadily on and not flashing, the steam cleaner is ready for use (**S**). Refer to the indicator lights section on page 11 for more information on indicator lights.

6. Aim the steam nozzle (and any attached accessory) towards the surface you want to steam, then press and hold the steam trigger.

⚠ WARNING Never aim the steam nozzle or any accessory towards yourself, other people, children, pets, or plants.

7. Hold the trigger down to get a constant flow of steam. It is recommended to use a slight back-and-forth motion over the area you are steaming. Wipe the steamed areas with a clean cloth to remove loosened dirt and grime. It is recommended to clean the area while it is still wet. However, be cautious when cleaning surfaces such as metal that may still be hot.

NOTE: The green light may start flashing during use. This is normal due to unit heating up. If you notice a decrease in steam pressure, release the trigger until the green light stops flashing.

8. To effectively eliminate bacteria and other microorganisms, hold the nozzle (and any attached accessory) approximately 13 mm (1/2") away from the surface you are steaming. Hold the trigger down in the same spot for at least 5 seconds.
9. When you finished steaming, move the switch to the Off position (**O**), as indicated (**O**), and unplug the power cord from the outlet. Follow the storage steps on page 13 of this manual.
10. Engage the trigger lock during working breaks to prevent accidental trippings.

Using the steam trigger safety lock

The steamer has a trigger and a safety lock. The trigger controls the steam coming out of the nozzle.

1. Use the safety lock to avoid accidental tripping. When the trigger is not in use, lift the safety lock and place it in position **(P - Q)**.

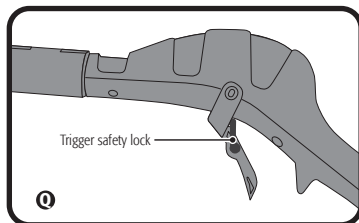
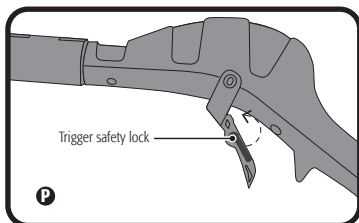

Flow adjustment

The flow adjustment knob allows you to control the amount of steam at any time during use **(R)**.

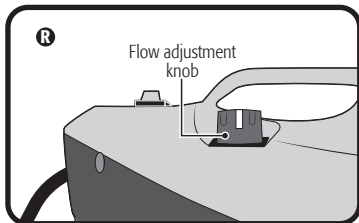

Adding water

Water can be added at any time during use. Ensure there is enough water in the steam cleaner. Use the indicator lights to help determine when to add more water.

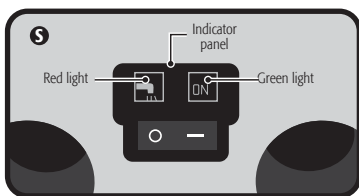

Indicator light panel

- **Flashing green light:** The unit is heating up.
 - **Green light on:** The steam cleaner is hot and ready to use.
 - **Flashing red light:** Low water level indicator. More water is needed. Refill the water tank and press the trigger once. The light will stop flashing, and the green light will blink, indicating that the water is heating.
 - **Alternating flashing red and green lights:** Low power mode is activated.
 - **Flashing red and green lights simultaneously:** The water temperature in the tank is too high. This condition occurs when the tool is used without a full water tank. The tank includes a steam condensation system that condenses the remaining vapor in the gun and hose when the trigger is released to prevent overpressure of the components. When the machine is operated without the right amount of liquid in the tank, the condenser cannot cool the vapor down, and it escapes through the tank cap.
- ⚠ WARNING** Do not open the tank cap while observing steam escape. Turn off the unit and let it cool. Then, open the cap and fill the tank. Turn on the equipment back.. Add water and then turn off the unit or press the trigger once to awaken the system from standby mode.
- **Red light on:** The unit may need repair. Contact the TRUPER Authorized Service Center.

Using the steam trigger safety lock

The automatic shut-off prevents the system from overheating. The heater and pump will shut off automatically if the water runs out or if the tank overheats. After ensuring there is enough water in the tank, place the switch in the off position and then turn on the equipment. Wait until the green indicator is on and indicates that the steam cleaner is ready to use.

Low water level indicator

The low water level indicator prevents the system from overheating. When the unit has low water, the red light will flash. Refill the tank with water and wait for the red light to turn off, then wait for the green light to stop flashing and be steadily on **(S)**. Your steam cleaner will now be ready for use.

It is recommended to check the tank water level and refill if necessary before waking the system from low power mode to prevent the tank temperature from arising.

Low power mode

The low power mode efficiently activates a standby mode when not using the tool for more than 5 minutes. When the unit is in low power mode, the red light and the green light will flash alternately (**S**). Press the trigger once to wake the system from standby mode and wait until the green light is on.

Operating tips

Before steaming, always ensure the material is suitable for steam cleaning. Do not use it on surfaces that cannot withstand 212°F or higher.

⚠ WARNING DO NOT attempt to use the wall and floor nozzle included with this unit for cleaning purposes. The wall and floor nozzle is designed only for wallpaper removal. It is not recommended to use this unit on self-adhesive vinyl tiles.

⚠ WARNING Pressurized steam may bounce off the cleaning surface. Use safety goggles to prevent steam from bouncing into the eyes.

⚠ WARNING Hot steam and parts can cause injuries, such as skin burns or property damage. Temperatures exceed 212°F. Use safety gloves during the use of this product.

- Press and hold the trigger as needed. Use the soft bristles on the nylon brush or the large cleaning tool to brush off dirt, grease, unwanted dried paint, etc. Do not scrub the surface too hard unless cleaning tiles or stone.

- Fill the tank with tap water or distilled water when using the steam cleaner. Never use detergents or other additives.

- When steaming a material for the first time, clean a small, hidden, and inconspicuous area and wait for 24 hours before checking if the material has been adversely affected.

When cleaning upholstery or clothing, DO NOT apply so much steam that it saturates the material. Too much steam can leave water marks or other damage. If any material has been adversely affected, **DO NOT CONTINUE USING IT!**

- This unit is intended for indoor use only. Do not use it outdoors.

- Exercise extreme caution when working on slopes and stairs.

- Always walk forward. Never run.

- Always use the carrying handle to transport the equipment.

Floors and carpets

- This steam cleaner is not recommended for use on surfaces that can be damaged by heat or water. This includes self-adhesive vinyl tiles or untreated wood floors, as the steam can cause the floorboards to swell. Steam can also remove wax-treated floors shine. Always consult with the surface manufacturer before using the steam cleaner.

- Carpets may contain stain-resistant treatments that can be affected by steam cleaning. Test clean a small, hidden area of the carpet and wait for 24 hours to check for any unusual effects on the carpet. If this occurs, stop using. Check with your carpet provider for more information.

- When mopping floors with steam, work from the farthest point backward on the floor to avoid walking on freshly cleaned areas. The cotton cloth will absorb dirt and moisture during mopping. However, upon completion, you may notice that the floors are still damp. In that case, let the floor air dry. You can use a fan to ease drying.

Windows and tiles

- When using the window nozzle, be careful not to pick up dirt or gravel particles with the rubber blade. This could scratch the glass.

- Old glass and stained glass can be fragile and may crack under the extreme temperatures emitted by this steam cleaner.

- Do not use it on glass when the temperature is below 32°F. Glass can crack in cold temperatures.

- If your window has been treated or coated in any way, consult with the manufacturer before using this steam cleaner.

Upholstery and fabrics

- Upholstery and fabrics may contain stain-resistant treatments that can be affected by steam cleaning. Test clean a small, hidden area and wait for 24 hours to check for any unusual effects. If this occurs, stop using. Check with the material provider for more information.

- Always check the garment label or consult with the clothing retailer before steam cleaning.

For genuine spare parts or accessories purchasing for the electric steam cleaner, please contact the TRUPER Authorized Service Center.

⚠ WARNING Disconnect the power cord before performing any maintenance tasks. If the power is still connected, the unit could accidentally turn on while performing maintenance tasks, which could result in personal injury.

1. Thoroughly inspect the electric steam cleaner for worn, loose, or damaged parts. If any repair or replace is needed, contact the TRUPER Authorized Service Center.
2. Carefully examine the appliance cord for signs of excessive wear or damage. If it is worn or damaged, replace it immediately.

Storage

1. Ensure the unit is turned OFF (O) and hold the trigger until all pressure is released.
2. Make sure the power cord is disconnected. Let the steam cleaner cool for at least 20 minutes before storing it.
3. Remove all accessories from the trigger.
4. Empty any remaining water in the tank. NEVER store the unit with water in the container.
5. Wipe down the cooled unit with a cloth and store the steam cleaner indoors, in a clean, dry, and enclosed place, out of the reach of children and animals.

Recycling and disposal

The product comes in packaging that protects it during shipping. Keep the package until you are sure that all parts have been delivered and the product is working correctly. Recycle the package afterward or store it for long-term storage.



Electrical and electronic products should be treated separately and should not be disposed of with household waste. Recycle where facilities exist. Check with your local authority or store for recycling regulations.

Transportation

- Turn the product off.
- Always transport the product by its handle.
- Secure the product to prevent it from falling or slipping.

Problem

Cause

Corrective action

The unit does not heat up.
The indicator does not flash or illuminate when placed in the "I" position (On).

- The unit is not plugged in.

- Check the power source cable, switches, fuses. If you find any damage, contact a qualified electrician for assistance.

- The household circuit breaker/GFCI has tripped or a fuse has blown.

- Reset the circuit breaker/GFCI or replace the fuse. If you need help, contact a qualified electrician.

- The unit is damaged or needs repair.
- Loose electrical connection.

- Discontinue use and contact TRUPER Authorized Service Customer Center.

The unit does not heat up.
The indicator lights do flash or illuminate when placed in the "I" position (on).

- The tank is empty.

- Refer to the tank filling procedure on page 10.

- The unit is damaged or needs repair in some other way.

- Discontinue use and contact TRUPER Authorized Service Customer Center.

NOTE: Always allow
Enough time for the unit to
heat up before pressing the
steam trigger.

Accessories do not remain
securely attached.

- Accessories are not installed correctly.

- Discontinue use and contact TRUPER Authorized Service Customer Center.

Floor surfaces appear
scratched after cleaning.

- The cotton cloth is dirty.
- Hard water residue on the floor.

- Wash the cotton cloth according to the instructions on page 8.
- Switch to distilled or demineralized water.

In the event of any problem contacting a TRUPER Authorized Service Center, please see our webpage **WWW.TRUPER.COM** to get an updated list, or call our toll-free numbers **800 690-6990** or **800 018-7873** to get information about the nearest Service Center.

AGUASCALIENTES **DE TODO PARA LA CONSTRUCCIÓN**
GRAL. BARRAGÁN #1201, COL. GREMIAL, C.P. 20030,
AGUASCALIENTES, AGS. TEL.: 449 994 0537

BAJA CALIFORNIA **SUCURSAL TIJUANA**
AV. LA ENCANTADA, LOTE #5, PARQUE INDUSTRIAL EL
FLORIDO II, C.P. 22244, TIJUANA, B.C.
TEL.: 664 969 5100

BAJA CALIFORNIA SUR **FIX FERRETERÍAS**
FELIPE ÁNGELES ESQ. RUIZ CORTÍNEZ S/N, COL. PUEBLO
NUEVO, C.P. 23670, CD. CONSTITUCIÓN, B.C.S.
TEL.: 613 132 1115

CAMPECHE **TORNILLERÍA Y FERRETERÍA AAA**
AV. ÁLVARO OBREGÓN #324, COL. ESPERANZA
C.P. 24080 CAMPECHE, CAMP. TEL.: 981 815 2808

CHIAPAS **FIX FERRETERÍAS**
AV. CENTRAL SUR #27, COL. CENTRO, C.P. 30700,
TAPACHULA, CHIS. TEL.: 962 118 4083

CHIHUAHUA **SUCURSAL CHIHUAHUA**
AV. SILVESTRE TERRAZAS #128-11, PARQUE INDUSTRIAL
BAFAR, CARRETERA MÉXICO CUAUHTÉMOC, C.P. 31415,
CHIHUAHUA, CHIH. TEL.: 614 434 0052

CIUDAD DE MÉXICO **FIX FERRETERÍAS**
EL MONSTRUO DE CORREGIDORA, CORREGIDORA # 35,
COL. CENTRO, C.P. 06060, CUAUHTÉMOC, CDMX.
TEL.: 55 5522 5051 / 5522 4861

COAHUILA **SUCURSAL TORREÓN**
CALLE METAL MECÁNICA #280, PARQUE INDUSTRIAL
ORIENTE, C.P. 27278, TORREÓN, COAH.
TEL.: 871 209 68 23

COLIMA **BOMBAS Y MOTORES BYMTESA DE MANZANILLO**
BLVD. MIGUEL DE LA MADRID #190, COL. 16 DE
SEPTIEMBRE, C.P. 28239, MANZANILLO, COL.
TEL.: 314 332 1986 / 332 8013

DURANGO **TORNILLOS ÁGUILA, S.A. DE C.V.**
MAZURIO #200, COL. LUIS ECHEVERRÍA, DURANGO,
DGO. TEL.: 618 817 1946 / 618 818 2844

ESTADO DE MÉXICO **SUCURSAL CENTRO JILOTEPEC**
PARQUE INDUSTRIAL # 1, COL. PARQUE INDUSTRIAL
JILOTEPEC, JILOTEPEC, EDO. DE MÉX. C.P. 54257
TEL.: 761 782 9101 EXT. 5728 Y 5102

GUANAJUATO **CÍA. FERRETERA NUEVO MUNDO S.A. DE C.V.**
AV. MÉXICO - JAPÓN #225, CD. INDUSTRIAL, C.P. 38010,
CELAYA, GTO. TEL.: 461 617 7578 / 79 / 80 / 88

GUERRERO **CENTRO DE SERVICIO ECLIPSE**
CALLE PRINCIPAL MZ.1 LT. 1, COL. SANTA FE, C.P. 39010,
CHILPANCINGO, GRO. TEL.: 747 478 5793

HIDALGO **FERREPRECIOS S.A. DE C.V.**
LIBERTAD ORIENTE #304 LOCAL 30, INTERIOR DE PASAJE
ROBLODO, COL. CENTRO, C.P. 43600, TULANCINGO,
HGO. TEL.: 775 753 6615 / 775 753 6616

JALISCO **SUCURSAL GUADALAJARA**
AV. ADOLFO B. HORN # 6800, COL. SANTA CRUZ DEL
VALLE, C.P.: 45655, TLAJOMULCO DE ZUÑIGA, JAL.
TEL.: 33 3606 5285 AL 90

MICHOACÁN **FIX FERRETERÍAS**
AV. PASEO DE LA REPÚBLICA #5140-A, COL.
EX-HACIENDA DE LA HUERTA, C.P. 58050, MORELIA,
MICH. TEL.: 443 334 6858

MORELOS **FIX FERRETERÍAS**
CAPITÁN ANZÚRES #95, ESQ. JOSÉ PERDIZ, COL.
CENTRO, C.P. 62740, CUAUTLA, MOR.
TEL.: 735 352 8931

NAYARIT **HERRAMIENTAS DE TEPIC**
MAZATLÁN #117, COL. CENTRO, C.P. 63000, TEPIC, NAY.
TEL.: 311 258 0540

NUEVO LEÓN **SUCURSAL MONTERREY**
CARRETERA LAREDO #500, 1B MONTERREY PARKS,
COLONIA PUERTA DE ANAHUAC, C.P. 66052, ESCOBEDO,
NUEVO LEÓN, TEL.: 81 8352 8791 / 81 8352 8790

OAXACA **FIX FERRETERÍAS**
AV. 20 DE NOVIEMBRE #910, COL. CENTRO, C.P. 68300,
TUXTEPEC, OAX. TEL.: 287 106 3092

PUEBLA **SUCURSAL PUEBLA**
AV. PERIFÉRICO #2-A, SAN LORENZO ALMECATLA,
C.P. 72710, CUAUHTLACINGO, PUE.
TEL.: 222 282 8282 / 84 / 85 / 86

QUERÉTARO **ARU HERRAMIENTAS S.A. DE C.V.**
AV. PUERTO DE VERACRUZ #110, COL. RANCHO DE
ENMEDIO, C.P. 76842, SAN JUAN DEL RÍO, QRO.
TEL.: 427 268 4544

QUINTANA ROO **FIX FERRETERÍAS**
CARRETERA FEDERAL MZ. 46 LT. 3 LOCAL 2, COL. EJIDAL,
C.P. 77710 PLAYA DEL CARMEN, Q.R.
TEL.: 984 267 3140

SAN LUIS POTOSÍ **FIX FERRETERÍAS**
AV. UNIVERSIDAD #1850, COL. EL PASEO, C.P. 78320,
SAN LUIS POTOSÍ, S.L.P. TEL.: 444 822 4341

SINALOA **SUCURSAL CULIACÁN**
AV. JESÚS KUMATE SUR #4301, COL. HACIENDA DE LA
MORA, C.P. 80143, CULIACÁN, SIN.
TEL.: 667 173 9139 / 173 8400

SONORA **FIX FERRETERÍAS**
CALLE 5 DE FEBRERO #517, SUR LT. 25 MZ. 10, COL.
CENTRO, C.P. 85000, CD. OBREGÓN, SON.
TEL.: 644 413 2392

TABASCO **SUCURSAL VILLAHERMOSA**
CALLE HELIO LOTES 1, 2 Y 3 MZ. #1, COL. INDUSTRIAL,
2A ETAPA, C.P. 86010, VILLAHERMOSA, TAB.
TEL.: 993 353 7244

TAMAULIPAS **VM ORINGS Y REFACCIONES**
CALLE ROSITA #527 ENTRE 20 DE NOVIEMBRE Y GRAL.
RODRÍGUEZ, FRACC. REYNOSA, C.P. 88780, REYNOSA,
TAMS. TEL.: 899 926 7552

TLAXCALA **SERVICIOS Y HERRAMIENTAS INDUSTRIALES**
PABLO SIDAR #132, COL. BARRIO DE SAN BARTOLOMÉ,
C.P. 90970, SAN PABLO DEL MONTE, TLAX.
TEL.: 222 271 7502

VERACRUZ **LA CASA DISTRIBUIDORA TRUPER**
BLVD. PRIMavera ESQ. HORTENSIA S/N, COL.
PRIMAVERA C.P. 93308, POZA RICA, VER.
TEL.: 782 823 8100 / 826 8484

YUCATÁN **SUCURSAL MÉRIDA**
CALLE 33 #600 Y 602, LOCALIDAD ITZINCAB Y MULSAY,
MPIO. UMAN, C.P. 97390, MÉRIDA, YUC.
TEL.: 999 912 2451

Code	Item	Brand
103206	LV-1800	TRUPER

Warranty. Duration: 1 year. Coverage: parts, components, and labor against manufacturing or operational defects, except when used under conditions other than normal, not operated according to the instructions, altered, or repaired by unauthorized personnel not authorized by Truper®. To enforce the warranty, present the product, sealed policy, invoice, or receipt, at the establishment where you purchased it or at Corregidora 35, Centro, Cuauhtémoc, CDMX, 06060, where you can also purchase parts, components, consumables, and accessories. It includes transportation expenses for the product resulting from its service network compliance. Tel. 800-018-7873. Made in/Hecho en China. Importer Truper, S.A. de C.V. Parque Industrial 1, Parque Industrial Jilotepec, Jilotepec, Edo. de Méx. C.P. 54257, Tel. 761 782 9100.

Stamp of the business. Delivery date:

